

NEY Product Information

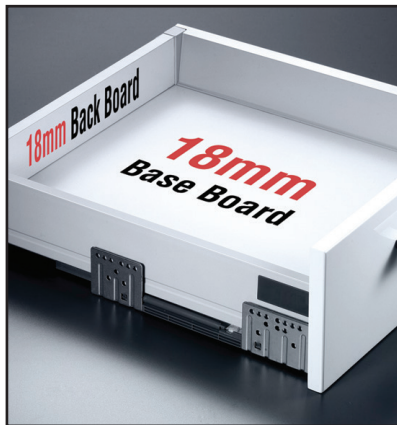

Data Sheet

Smart Slide Drilling Jig with Ruler



NEY Ltd (Head Office)
Stonebridge Trading Estate
Sibree Road
Coventry
CV3 4FD

t 024 7630 8100
f 024 7630 8101
e sales@ney.co.uk

NEY Ireland
Unit 22 Blaris Ind Estate
Altona Road
Lisburn
BT27 5QB

t 028 92 673 000
f 028 92 672 999
e ireland@ney.co.uk

NEY Scotland
Block 2 Units 1-2-3
Bandeath Ind Est
Throsk, Stirling
FK7 7NP

t 01786 814 814
f 01786 814 812
e scotland@ney.co.uk



Drill Jigs & Templates

Smart slide drilling jig with ruler

- The slide fixing holes can be easily drilled on both assembled (see 2 & 4) and pre-assembled cabinets (see 1).
- The jig can be clamped internally (see 2) or externally (see 3) to the assembled cabinet. The reference point can be set from the inside or underside of the cabinet base.
- The jig can be fixed in place with the locking device (see 3).
- The drilling positions for both standard and inside drawers can be determined by use of the adjustable template (see 6).
- The jig is suitable for SmartBox, SmartSlide single and full extension, SamBox and bottom mounted slides.

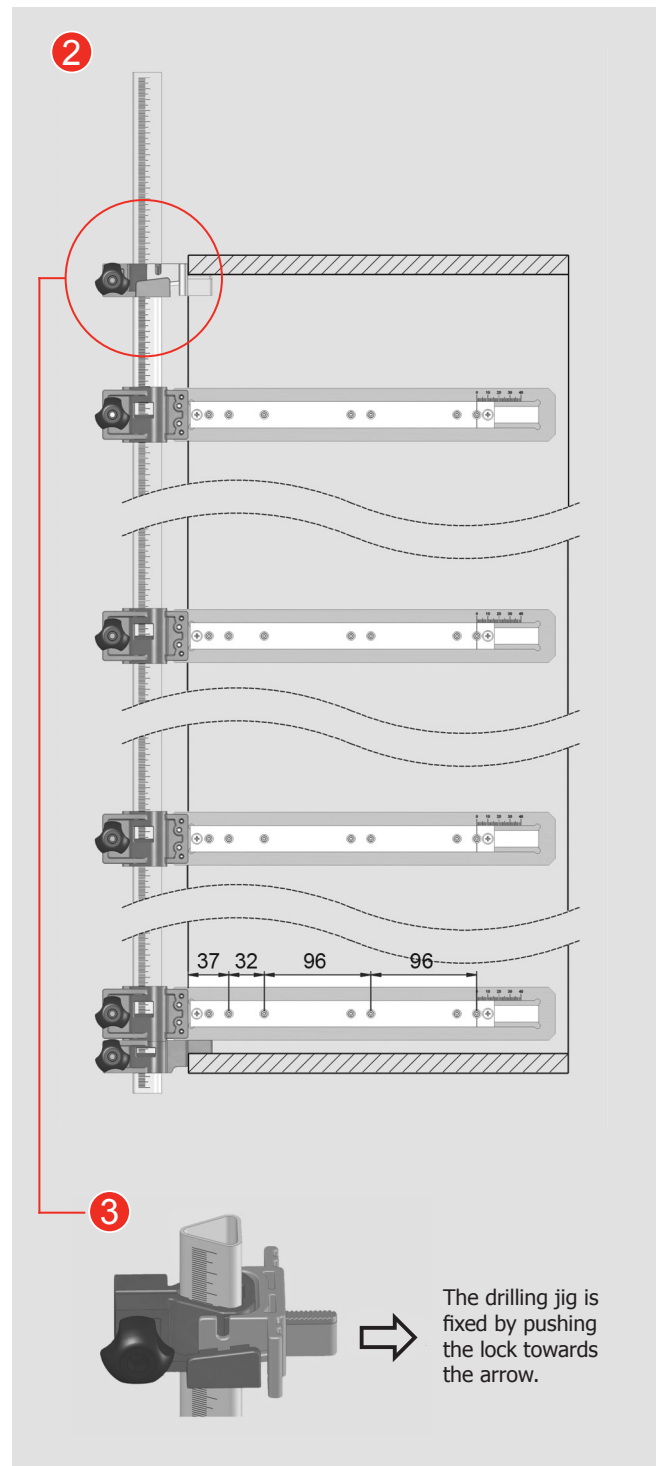
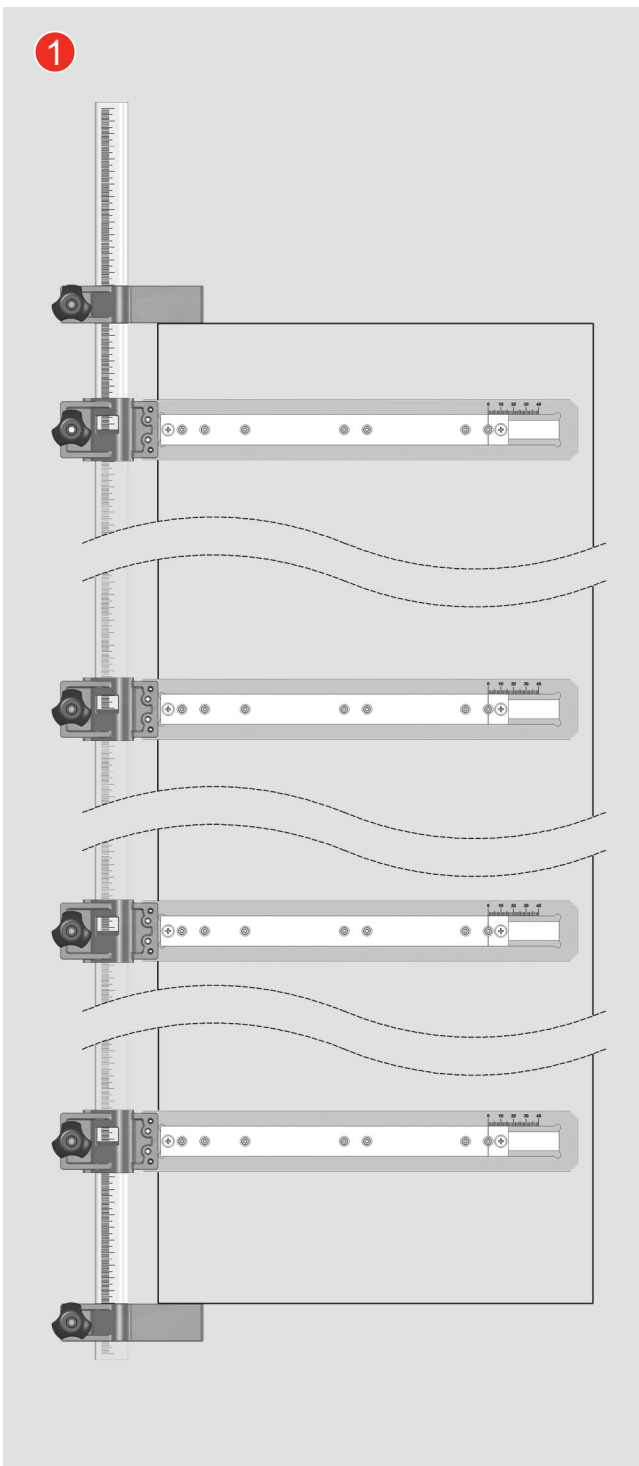

Drill Jigs & Templates

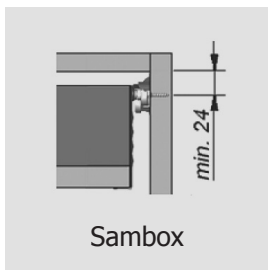
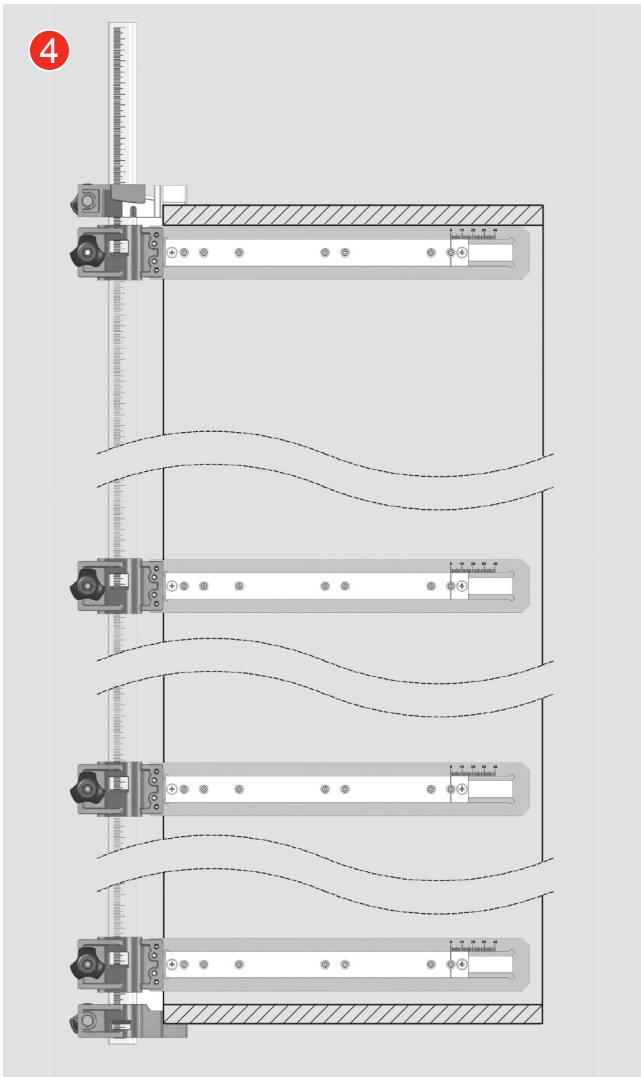

Sambox

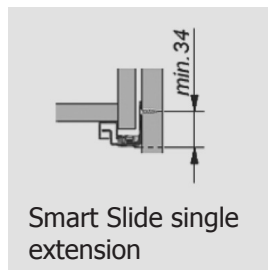

Smart Slide single extension

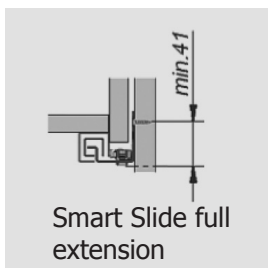

Smart Slide full extension

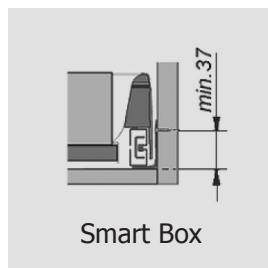

Smart Box

Drawer front panel template

Part Number	Pack Qty
110623 (Chipboard Screw)	1
110625 (Euro Screw)	1

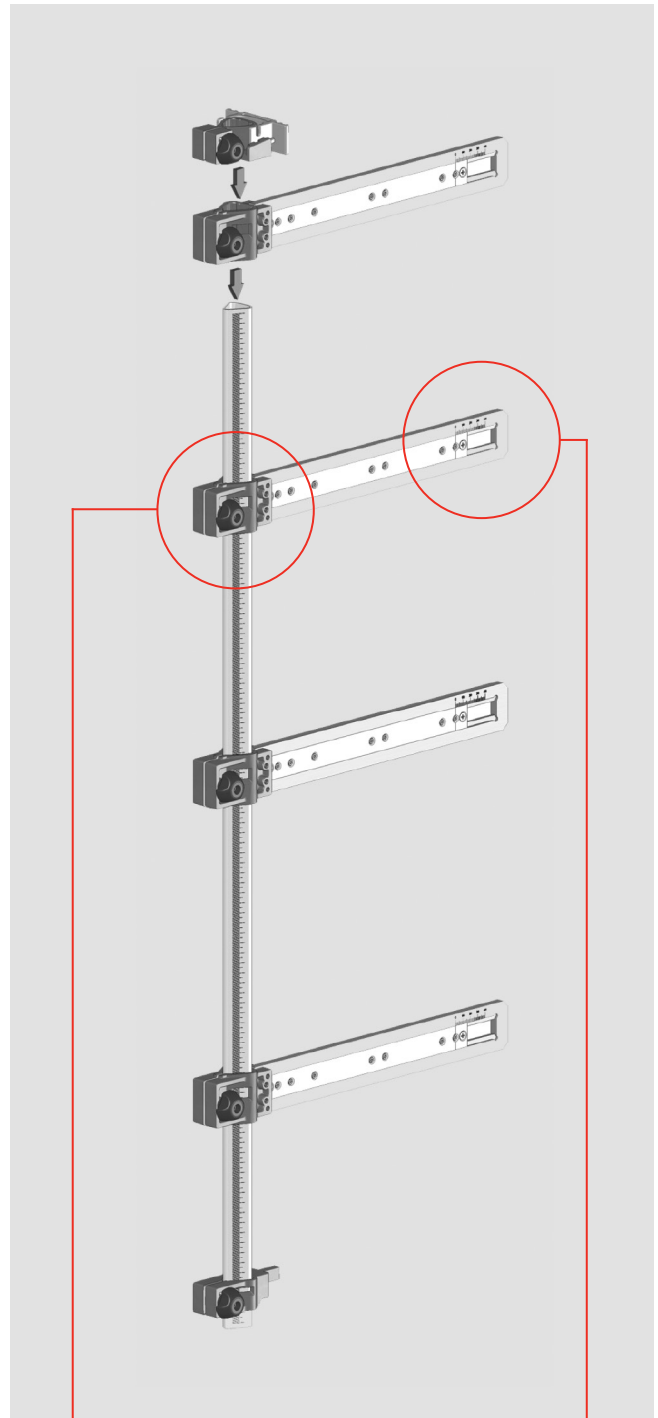

5

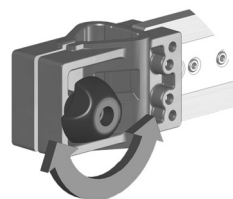

After finding the desired measurement on the ruler, the position is fixed by tightening the nut.

6

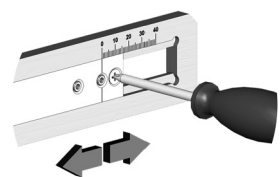

With the adjustable template, both standard and inside drawers can be assembled. The scale needs to be set to "0" for normal drawers.